

Ashland County Forestry Dept.
 304 W. Michigan St.
 P.O. Box 155
 Butternut, WI 54514
 (715) 769-3777

Shining Silver

Timber Sale Map
 Tract #7-24
 89 Acres
 Sec. 1 T-42-N R-1-W
 Town of Peeksville

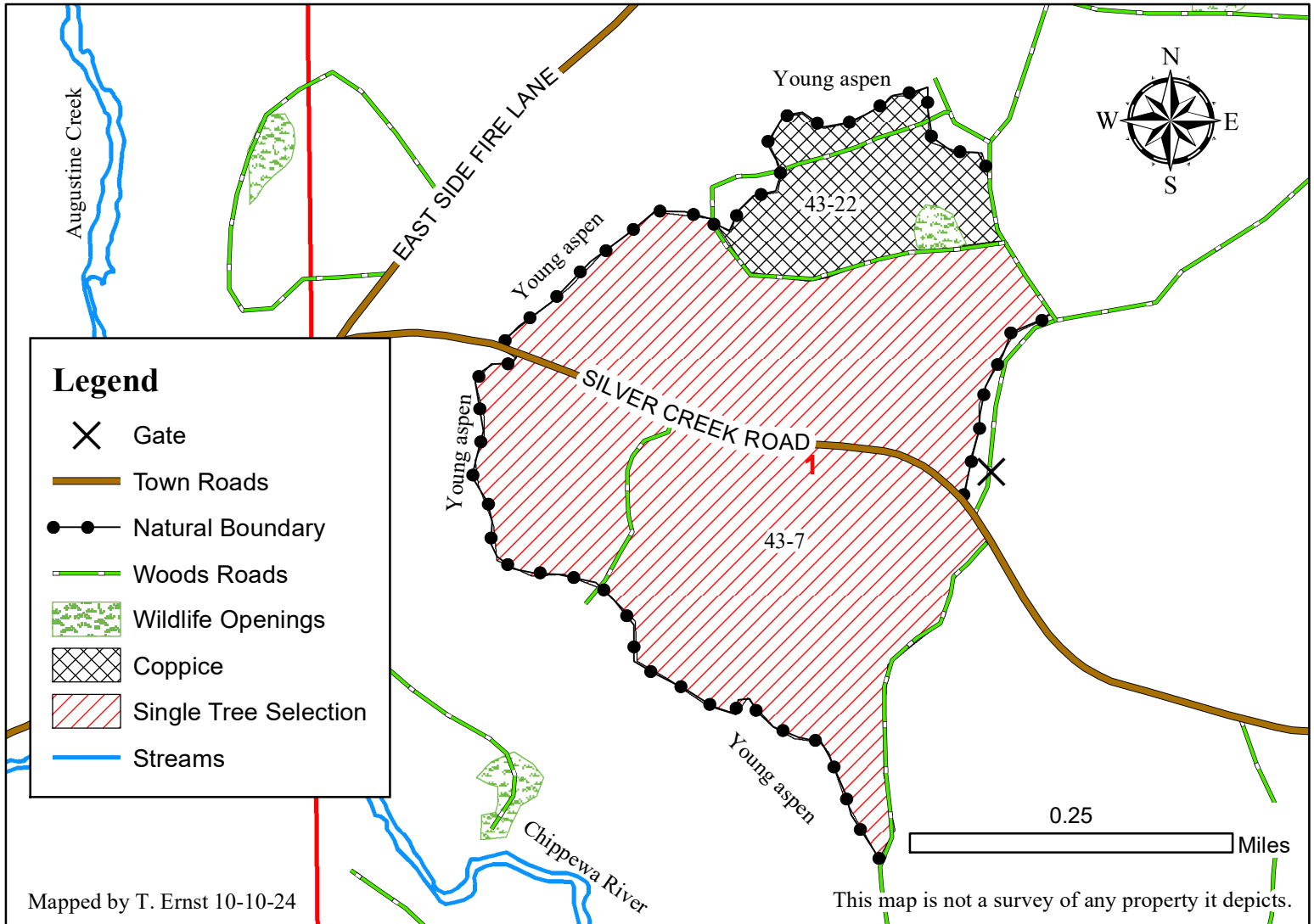

Mapped by T. Ernst 10-10-24

This map is not a survey of any property it depicts.

Cutting Specifications:

-Single Tree Selection: (77 Acres) Stand 43-7 Cut all orange marked trees within the sale boundary. Cut all ash, balsam, iron wood containing one or more 100" sticks. **Cut all aspen greater than 6"**

-Coppice: (12 Acres) Cut all trees greater than 1" within boundary area.

-Cut all aspen, balsam, ash, iron wood within sale boundary.

-Sale boundary includes town road, woods road and natural boundary.

Cutting Restrictions:

- Dry or frozen ground conditions only
- Excessive rutting or excessive damage to residual trees shall result in the suspension of logging.
- The sale must be cut progressively.
- No new woods roads shall be constructed without prior approval of the county forester.
- Care must be taken to preserve survey monuments.
- Care must be taken to not excessively damage existing saplings.
- Utilize all felled trees to a 4" minimum top diameter for pulpwood and 10" for sawlogs.
- Wildlife openings can be used for decking but must be cleared of debris when sale is completed.
- Berm or rock woods roads upon sale completion.
- All woods roads must be clear of debris upon completion of sale.
- Leave all snags standing unless they pose a safety hazard.

Species	Estimated Volumes	Min. Acceptable Bid
MX Pulp	525 cords	\$15.00/cord
Basswood Pulp	180 cords	\$1.00/cord
Aspen	100 cords	\$15.00/cord
Hard Maple Logs	37 mbf	\$120.00/mbf
Basswood Logs	70 mbf	\$100/mbf
MX Logs	21 mbf	\$100/mbf