

Ashland County Forestry Dept.
 304 W. Michigan Street
 P.O. Box 155
 Butternut, WI 54514
 715-769-3777

Timber Sale Map

Tract # 03-20
 Sec. 3 & 10 - T42N-R01E
 Town of Agenda

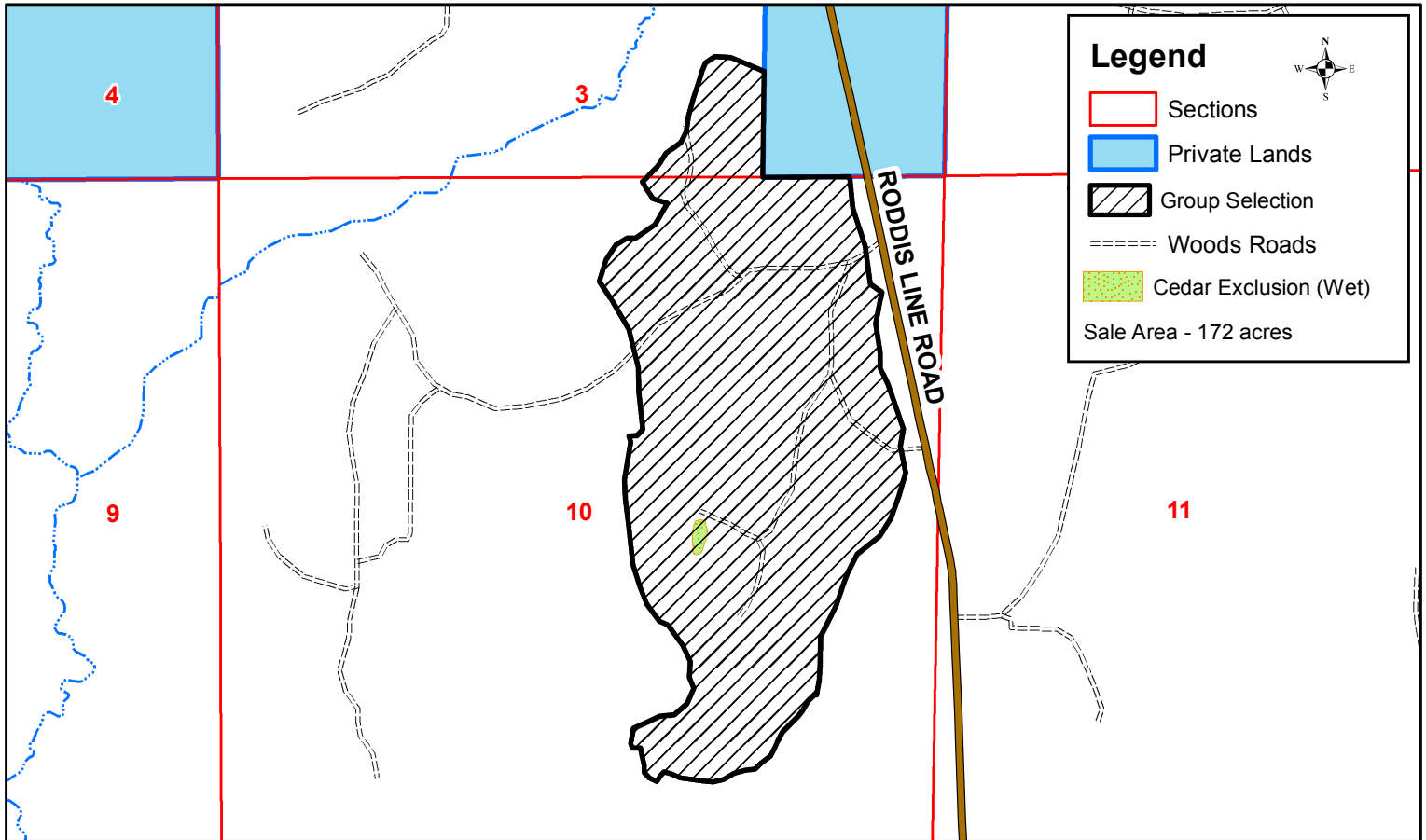

This map is not an actual survey of any property it depicts.

1 inch = 0.25 miles

S. Stack / M. Schultz 4-27-20

CUTTING RESTRICTIONS:

- Dry or frozen conditions.
- Excessive rutting or excessive damage to residual trees shall result in the suspension of logging.
- The sale must be cut progressively.
- No new woods road shall be constructed without prior approval of the county forester.
- Care must be taken to preserve survey monuments.
- Care must be taken to not excessively damage existing saplings.

CUTTING SPECIFICATIONS:

Group Selection:

- Cut all trees marked with orange paint and all merchantable ash, balsam fir and ironwood.
- Do not harvest in wet ash swales if soil is soft and rutting will occur.
- Cut all ironwood 1" DBH and greater when possible
- Care must be used to not damage hardwood regeneration.

Utilize all felled trees to a 4" minimum top diameter for pulpwood and a 10" minimum top diameter for saw logs.

<u>SPECIES</u>	<u>ESTIMATED VOLUME</u>	<u>MINIMUM ACCEPTABLE BID</u>
Mxd Hardwood Pulp	875 Cords	\$ 15.00 / Cord
Basswood Pulp	280 Cords	\$ 1.00 / Cord
Balsam Fir Pulp	10 Cords	\$ 15.00 / Cord
Basswood Logs	151 MBF	\$ 100.00/ MBF
Hard Maple Logs	34 MBF	\$ 120.00/MBF
Mx Hwd Logs	10 MBF	\$ 100.00/MBF
Ash Logs	74 MBF	\$ 100.00/MBF
Red Maple Logs	28 MBF	\$ 100.00/MBF