

**ASHLAND COUNTY FOREST TIMBER SALE
HOT to TROTT - 22 ACRES TOTAL
TRACT # 8-21 SALE# _____
Section 22, 23, 26, 27 T44N R2W Town of Morse**

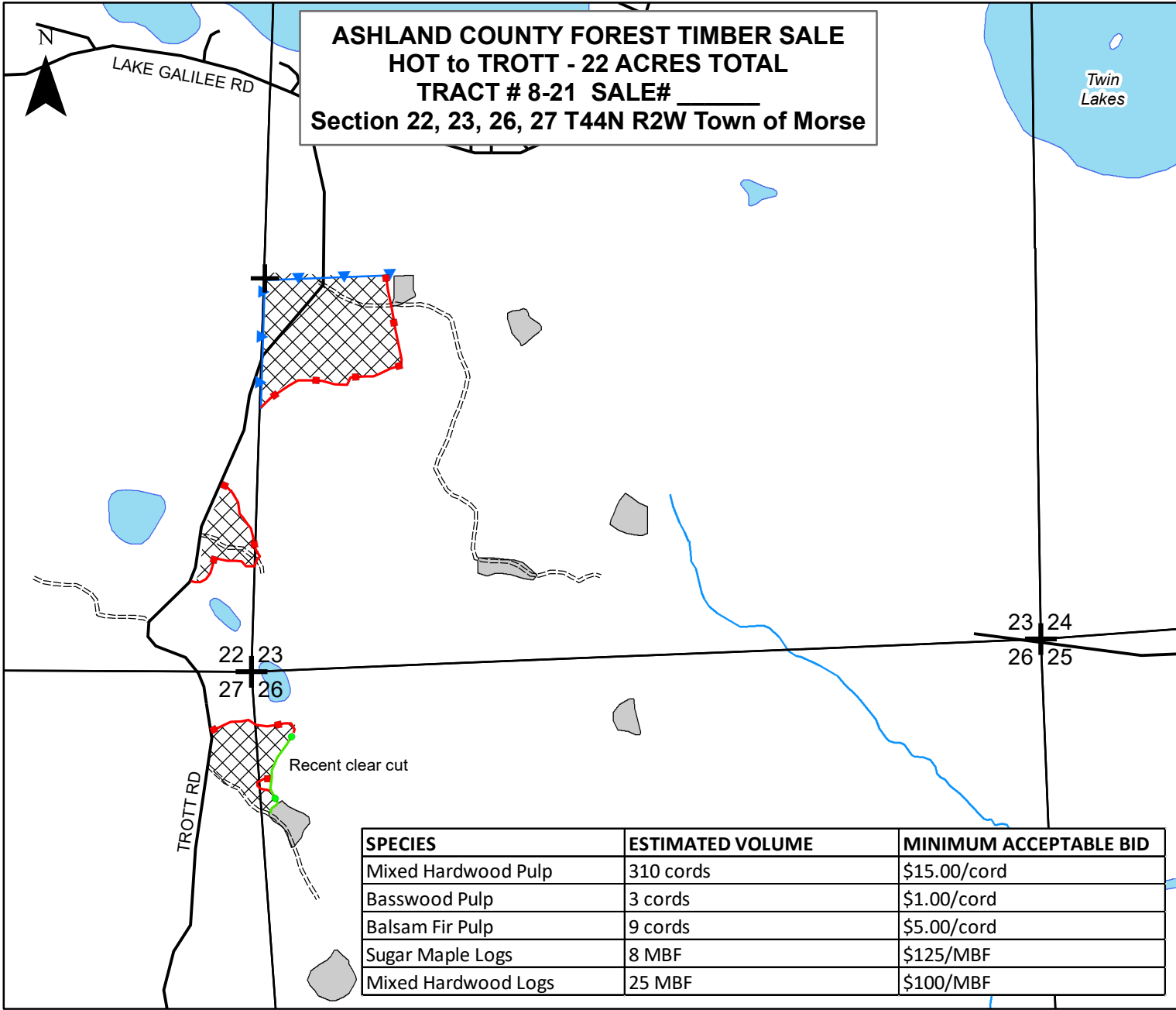

SPECIES	ESTIMATED VOLUME	MINIMUM ACCEPTABLE BID
Mixed Hardwood Pulp	310 cords	\$15.00/cord
Basswood Pulp	3 cords	\$1.00/cord
Balsam Fir Pulp	9 cords	\$5.00/cord
Sugar Maple Logs	8 MBF	\$125/MBF
Mixed Hardwood Logs	25 MBF	\$100/MBF



1" = 0.20 Miles

Mapped by A. Jehnke WDNR
4/2021

CUTTING SPECIFICATIONS:



Shelterwood Area (22 acres)(C1-S2): Harvest all trees 1" and larger except designated reserve trees and trees marked with GREEN PAINT.

- Designated reserve trees are all Hemlock, Cedar, White Pine, Spruce and Oak*.

**Special care should be taken to protect oak trees and saplings.*

- Utilize all felled trees to a 4" minimum top diameter for pulpwood and a 10" minimum top diameter for saw logs.

CUTTING RESTRICTIONS:

- Excessive rutting or excessive damage to residual trees shall result in the suspension of logging operations.
- The sale must be cut progressively
- Leave a 15 foot buffer strip around all vernal pools.
- No new woods roads shall be constructed without prior approval by the county forester
- Care must be taken to preserve any survey monuments.
- Berm woods roads when the sale is not active, and upon completion of logging operations.
- Retain suitable den trees and all snags that do not pose a safety hazard.
- Operations shall occur on dry summer or frozen winter frozen ground only.

Legend

- ===== Woods Roads
- Town Road
- Shelterwood Harvest
- Blue Paint Line
- Natural Boundary
- Red Paint Line
- Lake
- Survey Corner
- Wildlife Opening