

Good Boy Sale

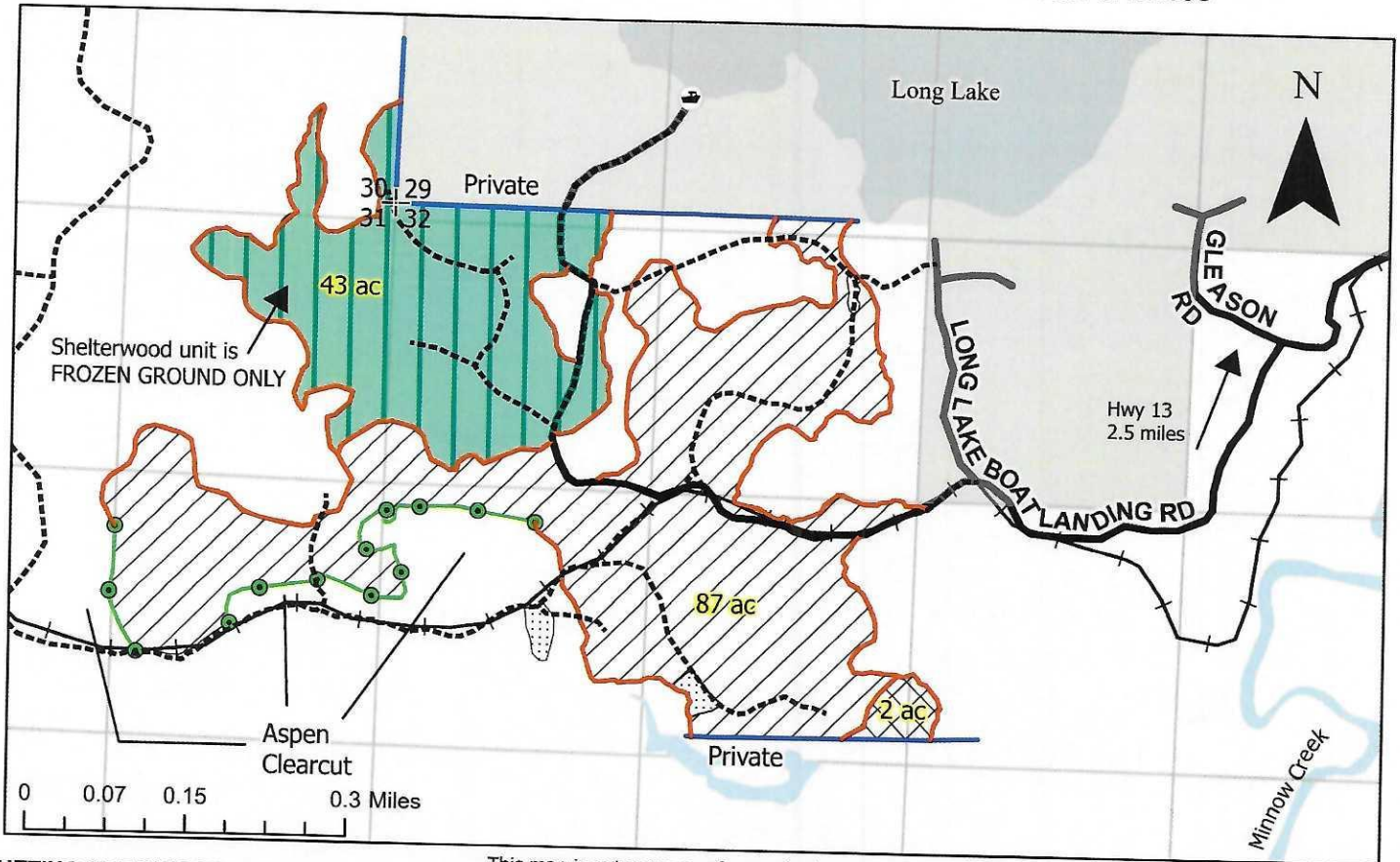

CUTTING SPECIFICATIONS:

This map is not a survey of any actual property it depicts.

Mapped by A. Jehnke 5/2024

- **Single Tree Selection (5-11), 87 acres:** Cut all trees marked with ORANGE PAINT. Cut all aspen, ash and ironwood that have one or more 8' pulp sticks.
- **Shelterwood (5-11), 43 acres:** Cut all trees with one or more 8' pulp sticks EXCEPT oak, yellow birch, hemlock, cedar, white pine, and any tree marked with GREEN PAINT.
 - Numerous oak saplings have been marked with green paint to help equipment operators avoid these trees.
- **Coppice (5-11), 2 acres:** Cut all stems 1" and larger EXCEPT oak, yellow birch, hemlock, cedar, white pine.

CUTTING RESTRICTIONS:

- In the shelterwood area, harvesting will be allowed with **FROZEN GROUND ONLY**.
- All other parts of the sale may be harvested with dry summer conditions.
- The main haul road is used as a snowmobile trail. The trail must be kept in safe and usable condition during snowmobile season.
- Berm roads when sale is not active and upon completion.
- Snag and den trees should be left standing if they don't pose a safety hazard.
- Excessive rutting or damage to residual trees shall result in the suspension of logging.
- The sale must be cut progressively
- No new woods roads shall be constructed without prior approval of the county forester.
- Care must be taken to preserve survey monuments.
- Care must be taken to not excessively damage existing saplings and residual trees.

SPECIES	ESTIMATED VOLUME	MINIMUM ACCEPTABLE BID
Maple Pulp	1050 Cords	\$15.00/cord
*Mixed Hardwood Pulp	300 Cords	\$1.00/cord
Aspen Pulp	50 Cords	\$15.00/cord
Balsam Pulp	20 Cords	\$1.00/cord
Hard Maple Logs	50 MBF	\$120.00/MBF
Soft Maple Logs	70 MBF	\$100.00/MBF
**Mixed Hardwood Logs	75 MBF	\$100.00/MBF

*Mixed Hardwood Pulp is approx. 190 cords ash, 40 cords oak, 70 cords basswood
 ** Mixed Hardwood Logs are approx. 28 MBF basswood, 23 MBF ash, 24 MBF oak

Legend

- Section Corners
- Red Paint Line
- Natural Boundary
- Blue Paint Line
- Woods Roads
- Beaver Pond
- Wildlife Opening
- Good Boy Sale Area
- Single Tree Selection
- Shelterwood
- Aspen Coppice
- Private Lands
- Ashland County Roads
- Snowmobile Trails
- 1/4 1/4 Lines
- Lake