

Ashland County Forestry Dept.
 304 W. Michigan St.
 P.O. Box 155
 Butternut, WI 54514
 715-769-3777

Iron Corner

No harvest between March 15 - May 31

Timber Sale Map
 Tract # 4-25
 75 acres
 T43N, R01W Sec 1 NENW,
 N1/2 NE, NENW, W1/2SE
 Jacobs Township

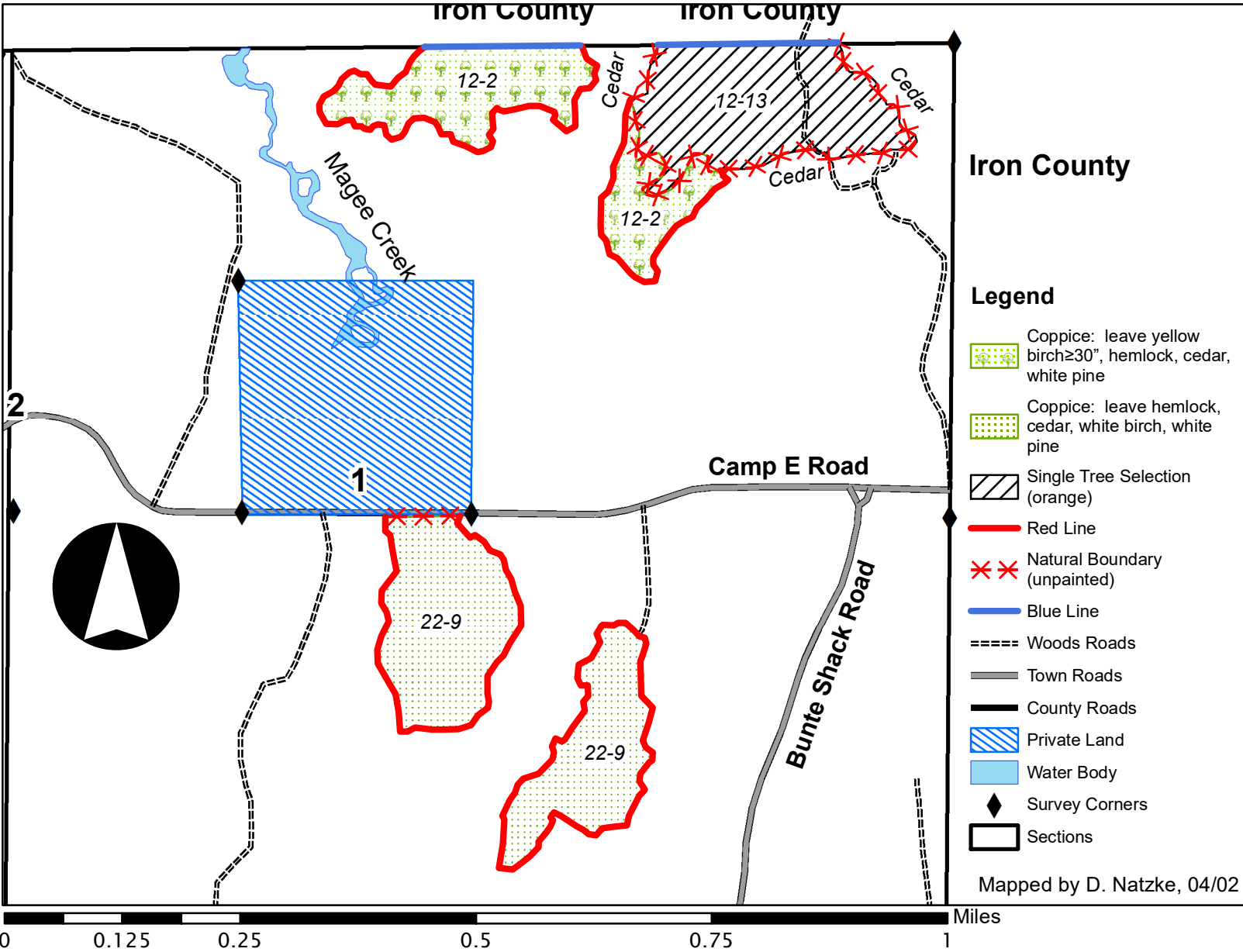

Species	Estimated Volumes	Min. Acceptable Bid
MX Pulp	225 Cords	\$15.00/cord
Aspen Pulp	200 Cords	\$15.00/cord
Balsam Fir	125 Cords	\$5.00/cord
Red Pine Pulp	125 Cords	\$5.00/cord
Red Pine Bolts	75 Cords	\$15.00/cord

Species	Estimated Volumes	Min. Acceptable Bid
Hard Maple Logs	1 MBF	\$120/MBF
Mx Logs	5 MBF	\$100/MBF

Cutting Specifications:

- Single Tree Selection (20 acres): Cut all orange marked trees.
- Clear Cut, north of Camp E Road (21 acres): Cut all trees yielding at least one 100" stick, except do not cut hemlock, white cedar and white pine. Do not cut yellow birch at or above 30" DBH.
- Clear Cut, south of Camp E Road (34 acres): Cut all trees yielding at least one 100" stick, except do not cut hemlock, white cedar, white pine and white birch.

1 inch = 0.16 miles

This map is representational only; it is not a survey.

Cutting Restrictions:

- Operations are limited to dry or frozen conditions.
- Operators must exercise care to avoid rutting in wet areas. Upland material used for operations in wet areas must be removed in order to close the sale.
- Excessive rutting or excessive damage to residual trees and regeneration will result in the suspension of operations.
- Utilize all pulp trees to 4" minimum diameter. Utilize all saw-logs to a 10" top-end diameter.
- Do not cut snags unless they pose a safety hazard.
- No new roads may be constructed without the county forester's approval. New roads and landings shall be closed to meet the county forester's requirements.
- Care must be taken to protect survey monuments.