

Ashland County Forestry Dept.
 304 W. Michigan St.
 PO Box 155
 Butternut, WI 54514
 715-769-3777

Timber Sale Map
 Tract # 5-25, 146 Acres
 Sec. 2 and 3 T43N R1W
 Town of Jacobs

Lost Nozzle

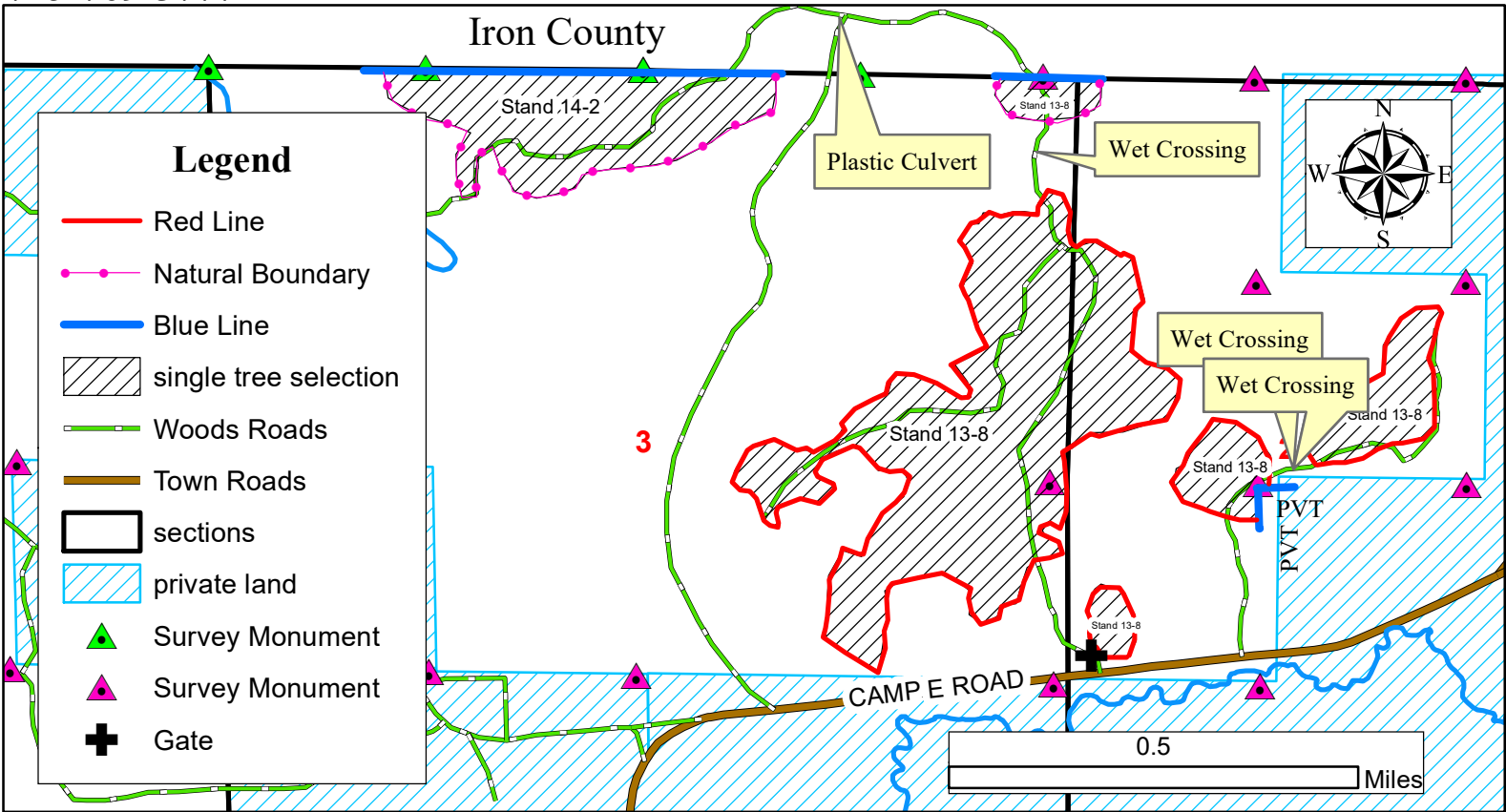

This map is not a survey of any actual property it depicts.

Mapped by Tom Ernst 4-15-25

Cutting Restrictions:

- Dry or frozen ground conditions only
- Excessive rutting or excessive damage to residual trees shall result in the suspension of logging.
- The sale must be cut progressively.
- No new woods roads shall be constructed without prior approval of the county forester.
- Care must be taken to preserve survey monuments.
- Care must be taken to not excessively damage existing saplings.
- Utilize all felled trees to a 4" minimum top diameter for pulpwood and 10" for sawlogs.
- Rock or berm roads when sale is complete.
- Retain all snags and den trees that do not pose a safety hazard.

Cutting Specifications:

- Single Tree Selection:** (146 Acres) Cut all trees marked with orange paint.
- Cut all ash, balsam fir and aspen with one or more 100" sticks.
- Cut all spruce less than 18" in diameter.
- Cut all ironwood 1" in diameter and larger.
- Sale boundary includes: red paint line, natural boundary and blue paint line
- Do not cut den or snag trees unless deemed a hazard.

Species	Estimated Volumes	Min. Acceptable Bid	Species	Estimated Volumes	Min. Acceptable Bid
MX Pulp	1300 Cords	\$15.00/cord	Hard Maple Logs	100 MBF	\$120/MBF
Aspen Pulp	50 Cords	\$15.00/cord	Mx Logs	1 MBF	\$100/MBF
Balsam Fir	10 Cords	\$5.00/cord	Ash Logs	15 MBF	\$100/MBF
Ash Pulp	75 Cords	\$1.00/cord	Red Maple logs	60 MBF	\$100/MBF
Spruce Pulp	15 Cords	\$15.00/cord			