

Ashland County Forestry Dept.
 304 W. Michigan Street
 P.O. Box 155
 Butternut, WI 54514
 (715) 769-3777

Matt's Mustard Sale

Timber Sale Map
 Tract # 3-23
 58 Acres
 Section 13 & 24 T42N R1W
 Town of Peeksville

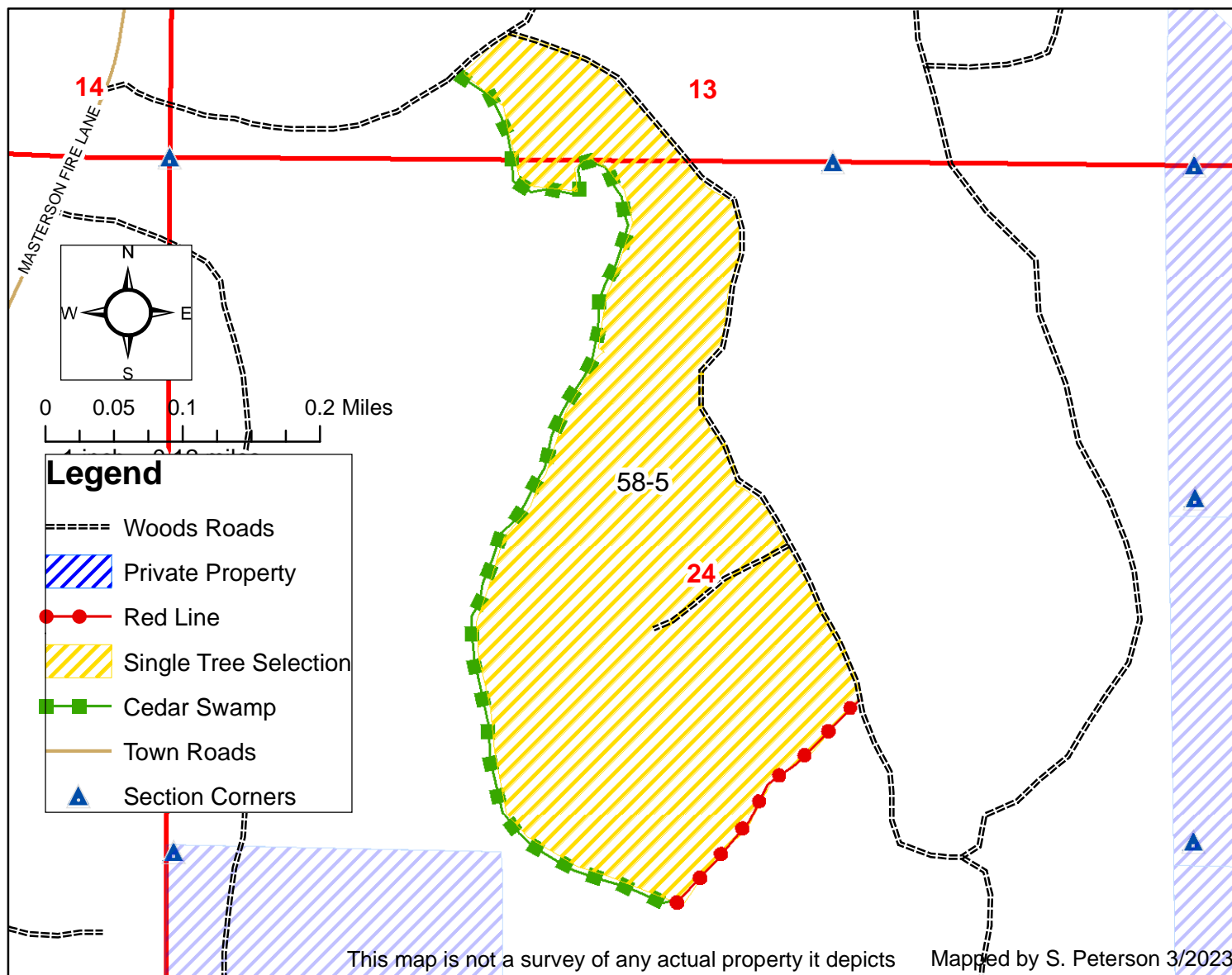

Cutting Restrictions:

- Excessive rutting or excessive damage to residual trees shall result in the suspension of logging.
- The sale must be cut progressively.
- No new woods roads shall be constructed without prior approval of the county forester.
- Care must be taken to preserve survey monuments.
- Care must be taken to not excessively damage existing saplings.
- Do not cut snags. Utilize all felled trees to a 4' minimum top diameter for pulpwood and a 10" diameter for sawlogs.

Cutting Specifications:

- Cut all trees marked with orange paint. Also cut aspen, balsam fir, ash and ironwood that contain at least one 100" pulp stick.
- Use extreme caution to protect hardwood saplings and poles from 4-8".

Winter Harvest Only No Exceptions

Species	Estimated Volumes	Min. Acceptable Bid
MX Pulp	500 cords	\$15.00/cord
Basswood Pulp	140 cords	\$1.00/cord
Balsam Fir	15 cords	\$5.00/cord
Hard Maple Logs	30 mbf	\$120.00/mbf
Basswood Logs	20 mbf	\$100/mbf
MX Logs	8 mbf	\$100/mbf