

Handwritten signature

Mellen School Forest
Timber Sale Tract MSF-1-23
21 acres

Cozy Valley Property
NWNW Section 14 T45N R2W
Town of Morse, Ashland County

DNR Forester Contact:
Avery Jehnke 920-604-5631
averya.jehnke@wisconsin.gov

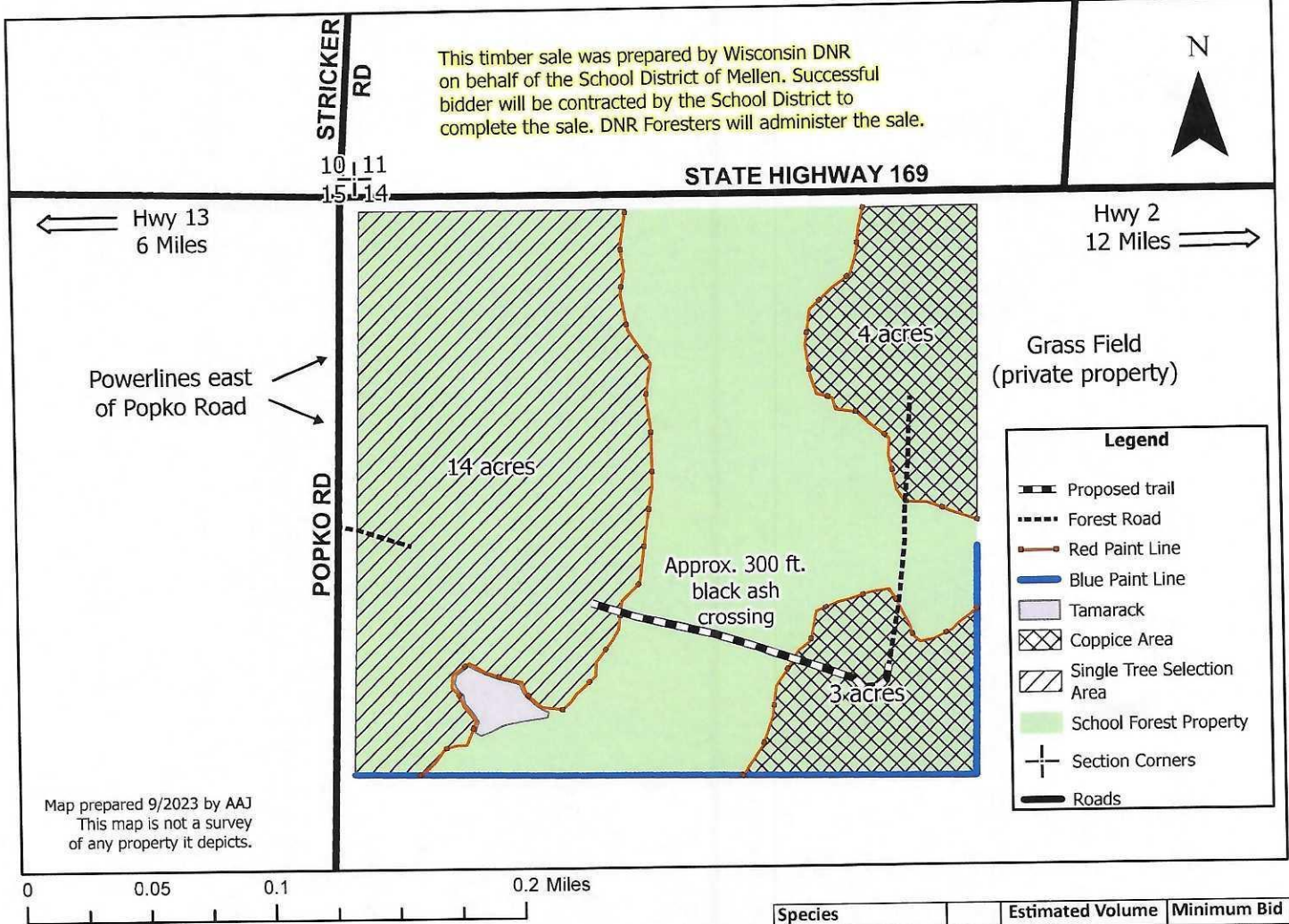

Harvest Specifications:

- **Single Tree Selection Area (14 acres):** Harvest all merchantable balsam fir, ironwood, and any tree marked with *ORANGE PAINT*.
- **Coppice Area (7 acres):** Harvest all stems 2" and larger except oak, spruce, hemlock, cedar, white pine, and any tree marked with *GREEN PAINT*.

Species		Estimated Volume	Minimum Bid
*Mixed Hardwood	Pulp	160 Cords	\$15.00
Aspen	Pulp	80 Cords	\$20.00
Basswood	Pulp	65 Cords	\$5.00
Balsam Fir	Pulp	8 Cords	\$1.00
Sugar Maple	Logs	1.26 MBF	\$300.00
Basswood	Logs	4.9 MBF	\$100.00
Ash	Logs	1.26 MBF	\$100.00
TOTAL MINIMUM BID			\$5,327.00

*Mixed hardwood pulp contains approx. 40 cords ash

Special Conditions:

- **Three-year contract- end date June 30th, 2027**
- Dry or frozen ground conditions only. Excessive rutting will not be tolerated.
- **STUDENT DEMONSTATION- a portion of this sale must be harvested between Labor Day and Thanksgiving holidays. One or more field trips to the site may occur while the sale is active.**
- Mill scale sale, administered by Mellen DNR Forester. Standard DNR conversion rates and scaling methods will be used.
- No decking on Popko Road without permission from the Town of Morse.
- A landing must be established off Poko road. The perimeter of the landing has been marked with purple paint. The landing must be level and clear of debris upon sale completion.
- Retain all snag and den trees that do not pose a safety hazard.
- Scatter all slash and cut to within 2 feet of the ground
- Equipment must be clean before entering sale area
- Minimum utilization on all species is 100" to a 4" top.

NO BID BOND REQUIRED- Performance bond of \$1,000 due within six weeks of bid opening.