

Ashland County Forestry Dept.
 304 W. Michigan Street
 P.O. Box 155
 Butternut, WI 54514
 (715) 769-3777

Timber Sale Map
 Tract # 4-21 - 123 Acres
 Section 14 T42N R1W
 Town of Peeksville

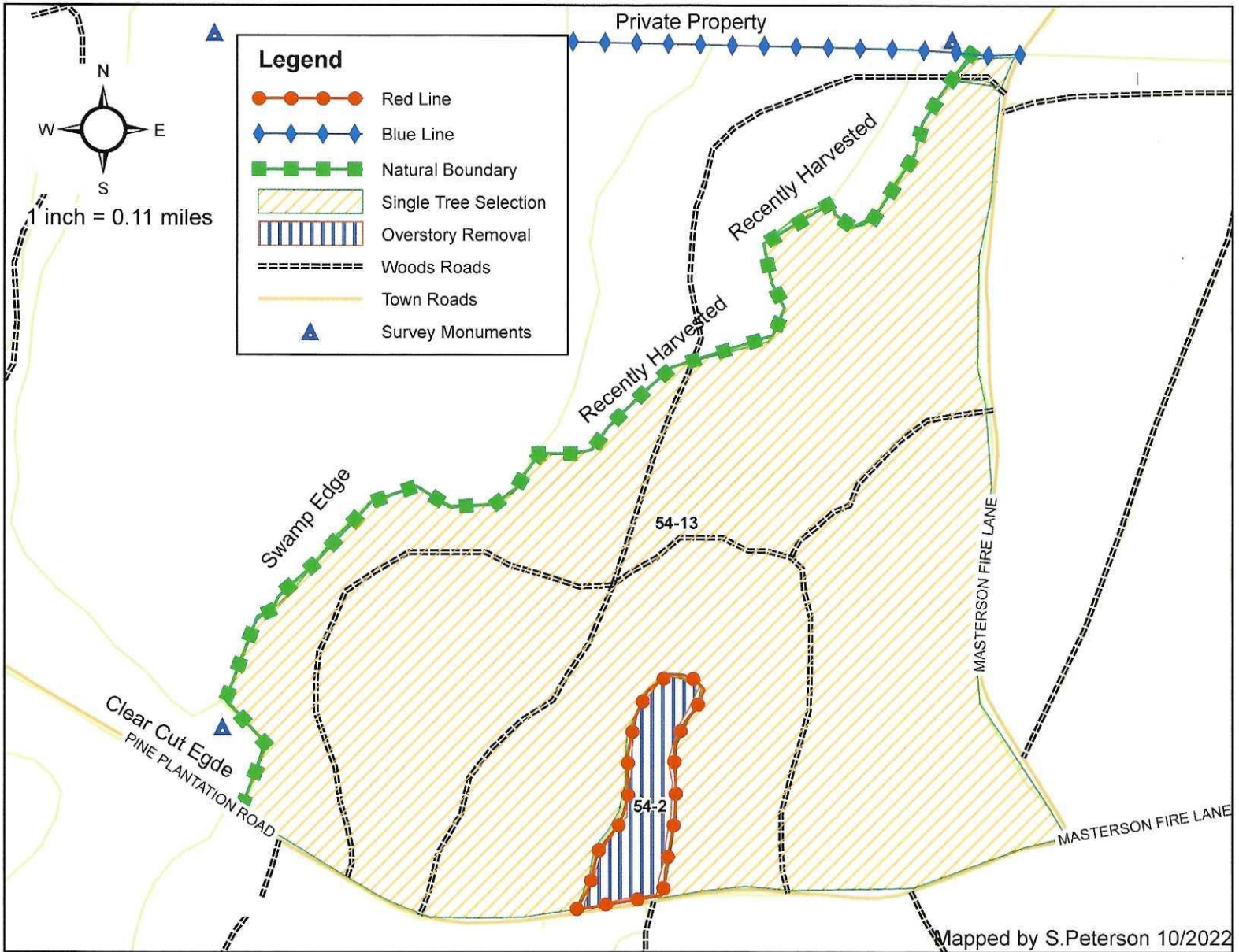

Cutting Restrictions:

Excessive rutting or excessive damage to residual trees shall result in the suspension of logging.
 The sale must be cut progressively.
 No new woods road shall be constructed without prior approval of the county forester.
 Care must be taken to preserve survey monuments.
 Care must be taken to not excessively damage existing saplings.

Do not cut snags. Utilize all felled trees to a 4" minimum top diameter for pulpwood and a 10" diameter for saw logs.

Cutting Specifications:

-Single Tree Selection harvest area (120 ac) – All trees marked with orange paint are designated for harvest, along with all ash, aspen, balsam fir, and ironwood that contains at least one 100" stick.

-Overstory Removal harvest area (3 ac) – Cut all trees over 8" within the red line. **Leave all spruce, yellow birch, cedar, hemlock, and oak.** Do not cut hardwood poles from 4-8".

SPECIES	ESTIMATED VOLUME	MINIMUM ACCEPTABLE BID
Mxd HW Pulp	1000 cords	\$15.00 / Cord
Basswood Pulp	100 cords	\$1.00 / Cord
Mxd HW Whole Tree Pulp	1300 cords	\$10.00 / Cord
Basswood Whole Tree Pulp	130 cords	\$1.00 / Cord
Hard Maple Logs	30 MBF	\$120.00 / MBF
Basswood Logs	10 MBF	\$100.00 / MBF
Mxd Logs	10 MBF	\$100.00 / MBF