

Ashland County Forestry Dept.
 304 W. Michigan St.
 P.O. Box 155
 Butternut, WI 54514
 (715)769-3777

Timber Sale Map
 Tract# 6-24
 75 Acres
 Sec. 10,14,15 T-42-N R-1-W
 Town of Peeksville

Windy Hills

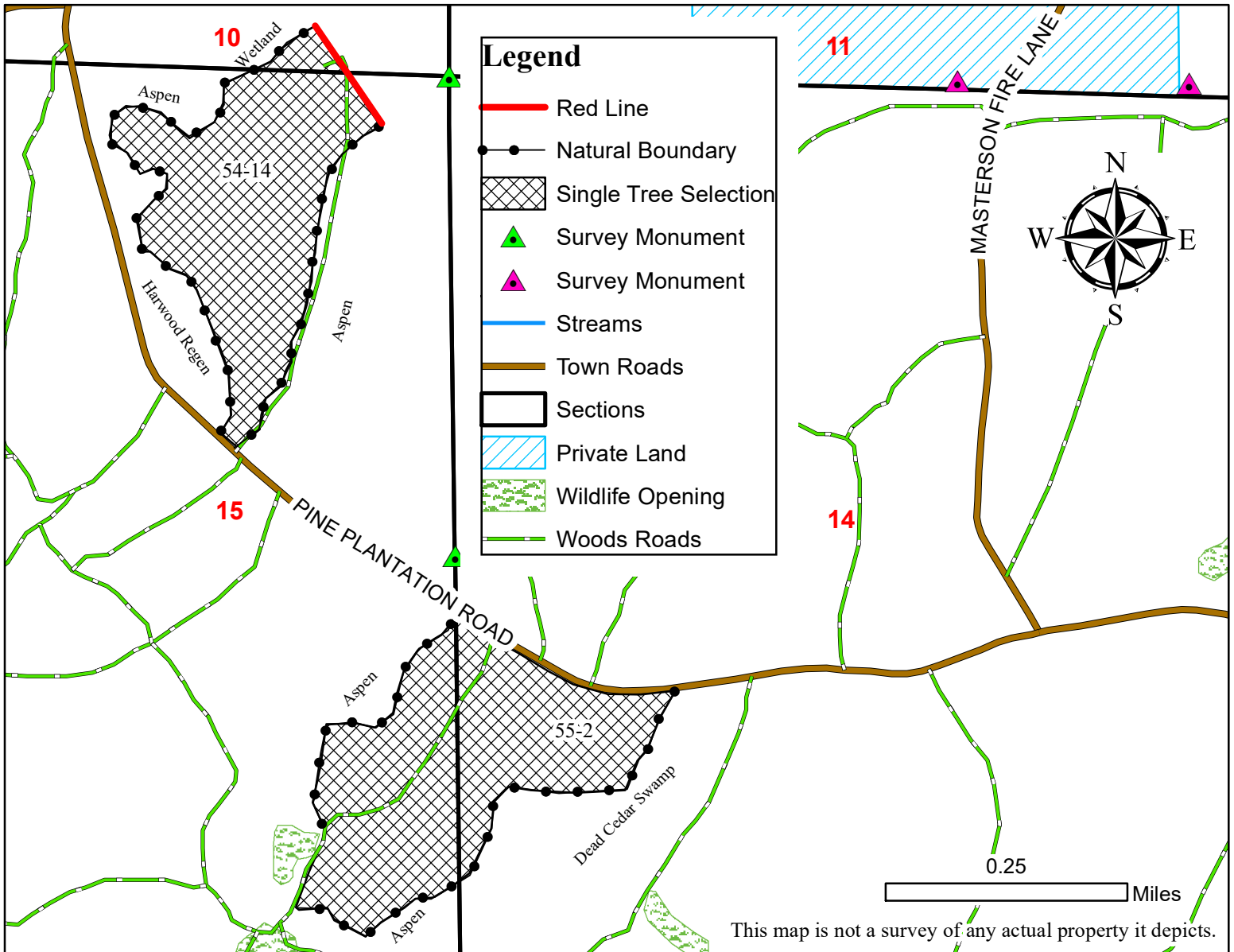

Cutting Specifications:

- Single Tree Selection:** (75 Acres) Stands 55-2 and 54-14 Cut all orange marked trees within the sale boundary.
- Cut all aspen, balsam, ash, iron wood within sale boundary.
- Sale boundary includes town road, woods road, natural boundary and red paint line.

Mapped by: T. Ernst 10-09-24

Cutting Restrictions:

- Dry or frozen ground conditions only
- Excessive rutting or excessive damage to residual trees shall result in the suspension of logging.
- The sale must be cut progressively.
- No new woods roads shall be constructed without prior approval of the county forester.
- Care must be taken to preserve survey monuments.
- Care must be taken to not excessively damage existing saplings.
- Utilize all felled trees to a 4" minimum top diameter for pulpwood and 10" for sawlogs.
- Wildlife openings can be used for decking but must be cleared of debris when sale is completed.
- Berm woods roads upon sale completion.
- All woods roads must be clear of debris upon completion of sale.

Species	Estimated Volumes	Min. Acceptable Bid
MX Pulp	450 cords	\$15.00/cord
Basswood Pulp	250 cords	\$1.00/cord
Balsam Fir	10 cords	\$5.00/cord
Hard Maple Logs	63 mbf	\$120.00/mbf
Basswood Logs	123 mbf	\$100/mbf
MX Logs	5 mbf	\$100/mbf